

BOMANN®

2 in 1

Fireplace and fan heater

Control via remote
control possible

Flame simulation

Fan heater function



without decoration



NEW! Electric fireplace
EK 6020 CB

- Electric fireplace with flame simulation and fan heater function
- 2-stage fan heater 900 W or 1800 W, switching-on as required or automatic (overheating protection)
- Flame effect switchable in 5 steps
- Glass front
- Wall mounting
- Control via remote control possible
- Removable window for easy cleaning
- Display may be faded-in to indicate the time, day of the week, brightness of the flames, heating power, room temperature display, timer programming
- On/off switch
- Close-up operation on the appliance
- 220–240 V, 50 Hz
- Heating power 900 W or 1800 W

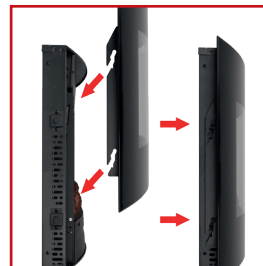

Glass removable



Fan heater function



Multifunction display

Color: Black
Article no.: 660 201
Article EAN-Code: 4 004 470 602 012
PU: 1
20"/40"/HQ Container: - / 720 / -

Dimensions (approx. W x H x D) and weight
Unit: 660 x 520 x 95 mm; 13 kg
Box: 755 x 625 x 190 mm; 14.1 kg
Delivery: xxx

C. Bomann GmbH
Heinrich-Horten-Straße 17
47906 Kempen
Tel.: +49 (0) 21 52 / 89 98 0
Fax: +49 (0) 21 52 / 89 98 911
mail@bomann.de
www.bomann-germany.com