

# LIVE GAMER 4K 2.1

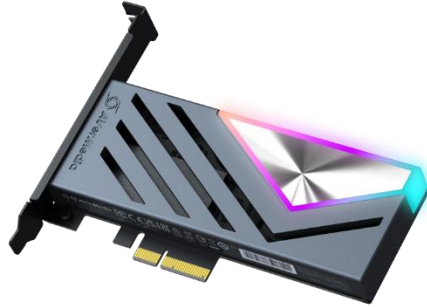

## User Manual

### Table of Contents

Introduction.....	2
Live Gamer 4K 2.1 (GC575).....	3
Key Features.....	4
Check Your Devices and Connection.....	6
System Requirements.....	6
Technical Specifications.....	7
Product Overview.....	8
RGB and Status Indicator.....	8
Installation.....	9
Contact Us.....	10
About AVerMedia.....	10

# Introduction

This document is your Reviewer's Guide for the Live Gamer 4K 2.1 (GC575). We have written this guide to provide you with the information you need to quickly and smoothly use the Live Gamer 4K 2.1 (GC575).

After a quick introduction of the Live Gamer 4K 2.1 and their target audience, we will dive into its key features, system requirements, and technical specs and show you how to set up and install the device. Lastly, this guide will finish with a link to our technical support team and with some brief information on AVerMedia's background.

Thank you for taking the time to use and try out our latest capture device, we hope you enjoy using it as much as we enjoyed making it. If you have any questions or suggestions on our products or need any further editorial assistance, please don't hesitate to contact us.

## Live Gamer 4K 2.1 (GC575)

### Take the Reins on Your Vision

The Live Gamer 4K 2.1 (GC575) is the world's premier HDMI 2.1 PCIe capture card.

Designed primarily for console and PC gamers with HDMI 2.1 compatible games and devices, such as modern consoles (PS5, Xbox Series X/S), GPUs, and monitors—it unleashes the full potential of these devices for streaming.

The Live Gamer 4K 2.1 opens up new horizons for PC and next-gen console gaming with 4K144 and 4K120 pass-through via HDMI 2.1. Prepare yourself for a gaming adventure that isn't just visually stunning but also offers unparalleled clarity and seamless gameplay. In addition, it doesn't just stop at 4K144; it takes it further with support for refresh rates of up to 240Hz in 1440p, an astounding 360Hz in 1080p, and ultra-wide resolutions for HDR/VRR pass-through. To fulfill different needs and for you to enjoy breathtaking clarity and fluidity in games. As for video capture, it supports up to 4K 60FPS, offering stunning game visuals to make your content shine. Moreover, you can elevate your gaming setup by customizing RGB lighting and sync up with the major RGB ecosystems.

## Key Features

- **4K144 / 4K120 Pass-Through**

Utilizing HDMI 2.1 technology, this feature ensures uncompressed video from PC and Next-Gen consoles (PS5, PS4 Pro, Xbox Series X/S, Xbox One X) gaming with 4K144 and 4K120 pass-through, providing HDR/VRR support for an immersive visual experience with unparalleled clarity and fluidity.

\*To fully utilize the Live Gamer 4K 2.1's performance, refer to [page 6](#) to check your hardware devices in advance.

- **Ultra-Wide Resolutions**

We heard you! Not only 4K at 144Hz, the GC575 also supports a refresh rate of up to 240Hz in 1440p, a stunning 360Hz in 1080p, and ultra-wide resolutions (3440x1440p at 100 / 120 Hz) for HDR/VRR pass-through. No matter which display you are using, you will find out the best resolutions and refresh rate combinations you need.

- **Ultra-Low Latency**

By directly interfacing through the PCIe slot to minimize the delay between input and display, the GC575 ensures that every command is translated to the screen with lightning speed. The ultra-low latency keeps you in **perfect sync** and ensures minimal lag. Capitalize on high refresh rates for streamers to win more in games, offering **ultra-smooth** and **less ghosting visuals** to give streamers a competitive edge.

- **4K60 Capture**

Your glory moments deserve nothing but the best! Capture stunning visuals at up to 4K 60FPS with incomparable clearness and smoothness to show your exceptional skills and drive your audiences wild.

- **Variable Refresh Rate**

Say goodbye to screen tearing and lag with our capture card's Variable Refresh Rate (VRR) support. Enjoy a competitive edge with smooth motion and responsiveness that keeps you immersed in the action, ensuring you never miss a crucial moment.

- **RGB Lighting Customization**

Showcase your unique style and individuality in the gaming setup by customizing RGB lighting, and sync with major gaming **RGB ecosystems** (currently collaborating with ASRock, MSI, and Gigabyte).

There are two ways to customize RGB lighting:

1. Using third-party RGB lighting software
2. Using the AVerMedia Gaming Utility tool (Please refer to [page 18](#) for RGB Control)

Download AVerMedia Gaming Utility [HERE](#).

- **Stability and Tidiness**

Effortlessly integrates into your desktop's PCIe slot, establishing a direct and efficient connection. This not only eliminates the need for extra cables and clutter but also ensures superior data transfer rates.

- **Design Concept**

The GC575 continues the family's industrial design with **clean lines and cutouts**, utilizing **continuous lines for visual coherence**. These lines form a diagonal, **ever-extending V shape** from top to front, seamlessly continuing to the back.

Additionally, the **concentric circle** metal plate in the center symbolizes the idea of "complete capture."



## Check Your Devices and Connection

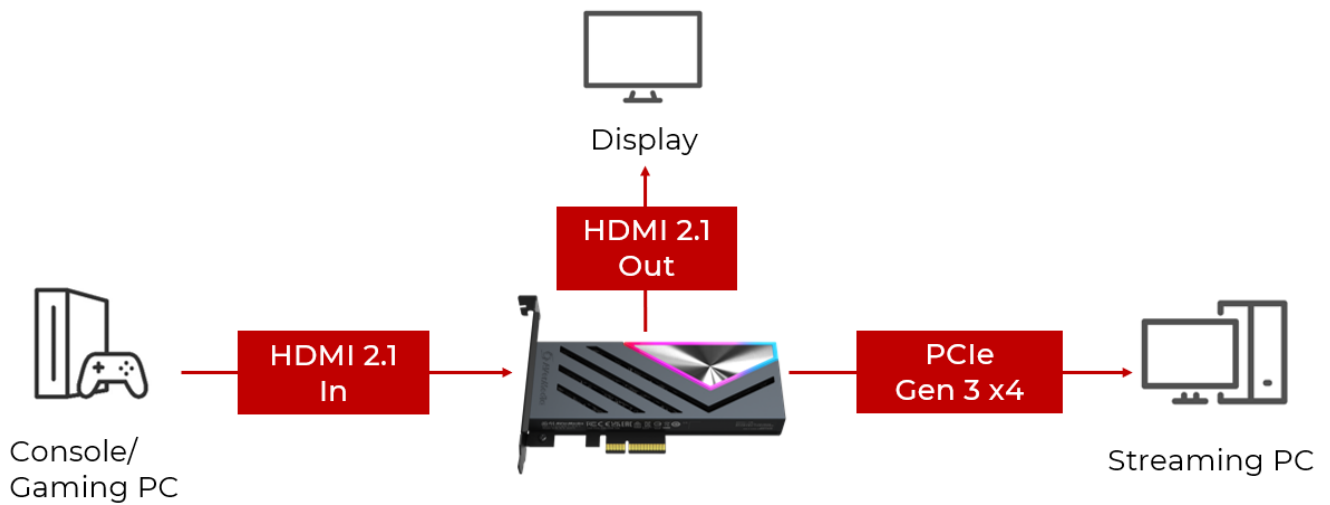

### Note:

- Always use the cables provided with your devices.
- Make sure that both your display and console (PS5, PS4 Pro, Xbox Series X/S, Xbox One X) support HDMI 2.1 connections.
- If your monitor supports built-in DSC (Display Stream Compression), be aware that the maximum supported video pass-through might be 4K120.

## System Requirements

- Windows® 10 x64 / 11 x64 or later
- Desktop: Intel® Core™ i5-6XXX / AMD Ryzen™ 3 XXX or above + NVIDIA® GeForce® GTX 1060 / AMD RX5700 or above
- 8 GB RAM recommended (Dual-channel)

## Technical Specifications

Interface	PCIe Gen 3 x4
Input & Output (Pass-through)	HDMI 2.1
Max Pass-Through Resolution	2160p144 HDR/VRR, 3440x1440p120, 1440p240 HDR/VRR, 1080p360 HDR/VRR
Max Capture Resolution	2160p60
Video Format	YUY2, NV12, RGB24, P010 (HDR)
Dimensions (W x D x H)	121 x 160.5 x 21.5 mm (4.76 x 6.32 x 0.85 in.)
Weight	150.5 g (5.31 oz.)
Supported Software	AVerMedia Assist Central AVerMedia Gaming Utility AVerMedia RECentral Firmware Update Tool
What's in the Box	Live Gamer 4K 2.1 (GC575) HDMI 2.1 Cable Quick Start Guide (We recommend using the included cables for connection)

Specifications are subject to change without prior notice. Please visit AVerMedia official website for the latest information.

## Product Overview

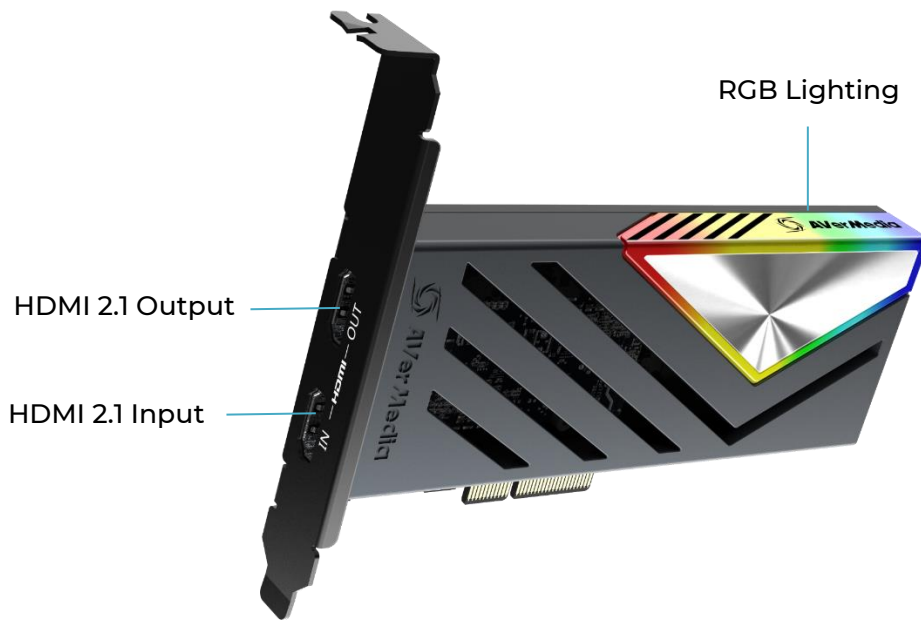

## RGB and Status Indicator

Blue Comet	Detecting Device
Rainbow Wave	Ready
Flashing Blue	Updating Firmware
Solid Red	Error: No Device Detected
Flashing Red	Error: Device Anomaly
Flashing Orange	Error: Connection Anomaly



# Installation

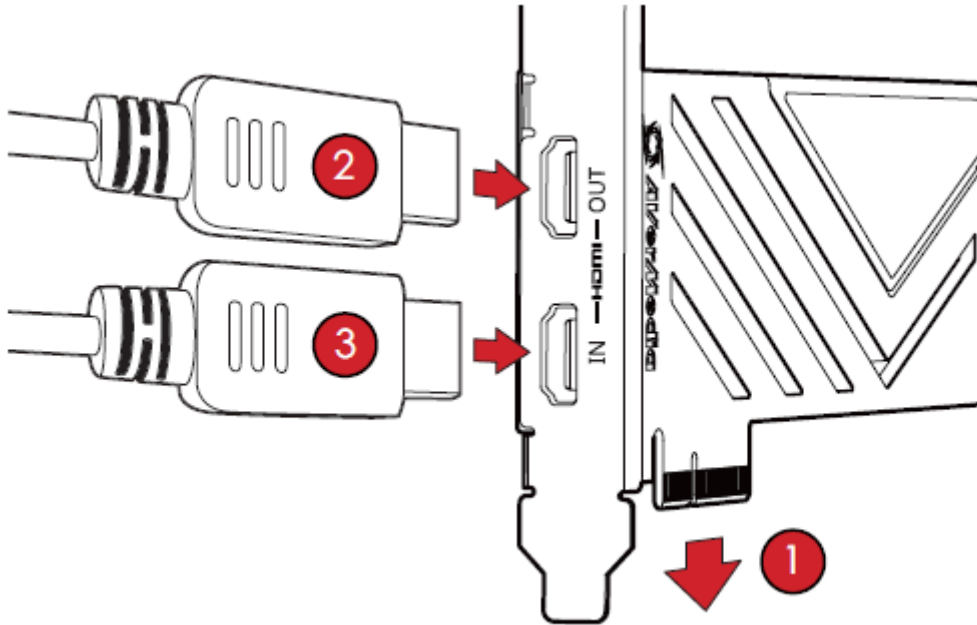

1. Shut down your PC and unplug its power cord. Insert LG4K 2.1 into a PCIe Gen 3 x4 slot and secure it.
  2. Connect your monitor to the HDMI-OUT port for pass-through of captured content.
  3. Connect your video source (console/graphics card/another PC) to the HDMI-IN port.
- Note: Do NOT unplug the PCIe card while the computer is running; it may cause your system to crash.



## Contact Us

Please contact us [here](#) should you have any questions or suggestions.

## About AVerMedia

AVerMedia Technologies specializes in digital video and audio technology. We provide cutting-edge, high-quality audio and video peripherals, professional capturing and streaming solutions, Edge AI technology, video collaboration solutions, and more. Our mission is to provide an enriched user experience and effective communication in education, content creation, and video communication via innovative and eco-friendly solutions.

AVerMedia is guided by a philosophy of contributing to society- whether through products that change customers' lives for the better or by ensuring our operations are socially responsible.

Connect with AVerMedia:

Website: <https://www.avermedia.com/>

LinkedIn: <https://www.linkedin.com/company/avermedia-technologies>