



# Accelero Xtreme IV

## High End Graphics Card Cooler

### Main Features

- Patented back side cooler lowers RAM and VRM temperatures
- Unmatched cooling performance - 300 Watts
- 3 ultra quiet 92 mm PWM fans with low noise impeller
- Patented fan holder eliminates the buzzing sounds
- 5 heatpipes
- Easier Installation without thermal glue
- Improved fan controller for NVIDIA graphics cards



 Carbon  
Neutral  
green.arctic.ac

[www.arctic.ac](http://www.arctic.ac)



# Accelero Xtreme IV

## High End Graphics Card Cooler

The **Accelero Xtreme IV** is a high performance cooler with a cooling efficiency to maintain super low temperatures even when overclocked. Incorporating ARCTIC's super quiet PWM fans means even on full load, you will no longer need to turn up the volume while gaming.

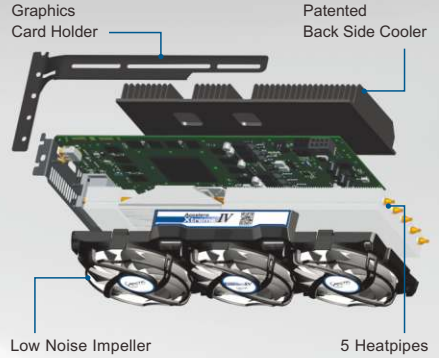

## Patented Back Side Cooler

Voltage Regulator ICs are heating up the complete board to a level which is not just for the ICs itself dangerous, but mainly lowers the service life of other components dramatically. Our patented back side cooler keeps the board and all components around the GPU on low temperature.



Back in Original  
Condition without  
any Marks

Lower VRM  
Temperature

Better  
Over-Clocking

Long Service  
Life

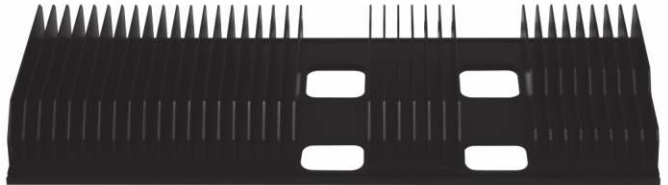

| Specifications              |  |
|-----------------------------|--|
| Max. Cooling Capacity       | 300 Watts  |
| Heatpipe                    | Ø 6 mm x 5   |
| Heatsink Material           | Aluminum Fins x 83, Thickness 0.3 mm                   |
| Fan                         | 92 mm, 900 - 2,000 RPM<br>(Controlled by PWM) x 3 Fans |
| Bearing                     | Fluid Dynamic Bearing                                  |
| Noise Level                 | 0.4 Sone   |
| Current / Voltage (per fan) | 0.12A / +12V DC  |
| Dimensions                  | 288 (L) x 104 (W) x 54 (H) mm                          |
| Net Weight                  | 991 g  |



### Compatibility

#### AMD Radeon:

R9 290(X), R9 285, 270(X), R7 265, HD8870, 7870 (XT,GHz), 7850, 6970, 6950 6870, 6850, 6790, 5870, 5850, 5830, 4890, 4870, 4850, 4830, 3870, 3850,3690

#### NVIDIA GeForce:

GTX 980, 970, Titan (Black), 780 (Ti), 770, 760 (Ti), 750 (Ti), 680, 670, 660 (Ti), 650 (Ti,Ti boost), 580, 570, 560 (Ti,SE), 550 Ti, 480, 460(SE), GTS 450, 250, 240 (OEM), GT 740

The Accelero Xtreme IV is compatible only with the graphics card using a standard size PCB with a width of 98 mm.

### Cooling Performance & Noise Level on NVIDIA GTX 770

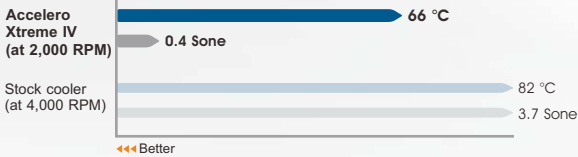

Award Winning ARCTIC fans for near silent cooling

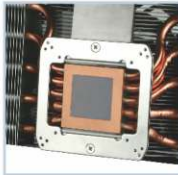

High performance MX-4 thermal paste

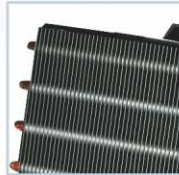

Heatsink for efficient dissipation