

## Wireless USB Adapter

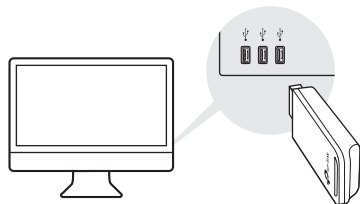

### 1 Connect to a Computer

Option 1: Directly



Option 2: Via the USB Extension Cable  
(If provided)

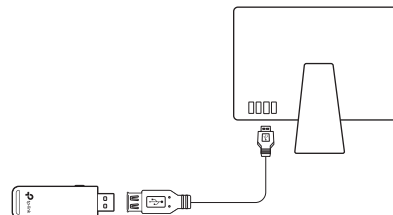

### 2 Install Driver and Utility

a. Download the driver and utility at <https://www.tp-link.com/download-center>

Note:  
If your computer has a CD drive, you can also run the included CD to install the driver and utility.

b. Unzip the downloaded folder and run the **Install.pkg**.

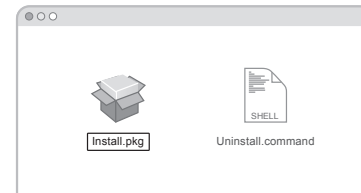

c. Follow the instructions to complete the installation.

### 3 Join a Wireless Network

Option 1: Via TP-Link Utility

a. Click  (TP-Link Utility) on the menu bar.

b. Select your Wi-Fi network and enter the Wi-Fi password when prompted.

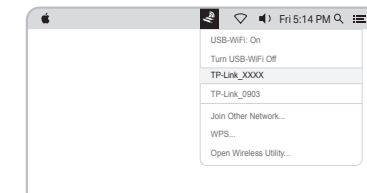

Option 2: Via Wi-Fi Protected Setup (WPS)  
(If your adapter has a WPS button)

a. Press the WPS button on your router.

b. Within 2 minutes, press and hold the WPS button on the adapter until the WPS progress window appears.

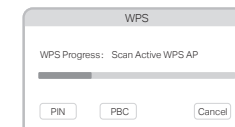
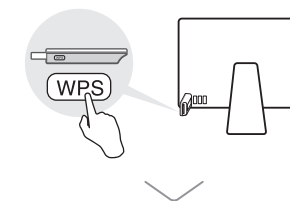



## 1 Connect to a Computer

### Option 1: Directly

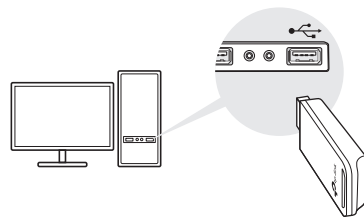

### Option 2: Via the USB Extension Cable (if provided)

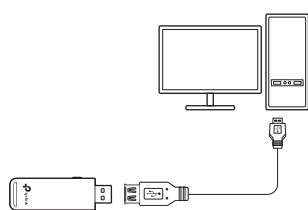

## 2 Install Driver

### a. Insert the CD and run the Autorun.exe.

Note:  
You can also download the driver or check the new release at <https://www.tp-link.com/download-center>

### b. Select **your adapter** and follow the instructions to complete the installation.

Note:  
If you can't install the driver successfully, disable the antivirus software and firewall, then try again.

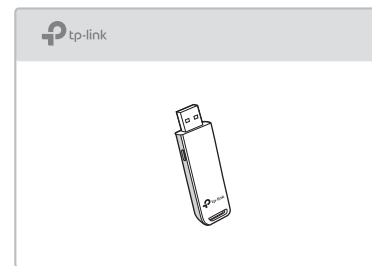

## 3 Join a Wireless Network

### Option 1: Via Windows Wireless Utility

#### a. Click the network icon ( or ) on the taskbar.

#### b. Select your Wi-Fi network, click **Connect** and enter the password when prompted.

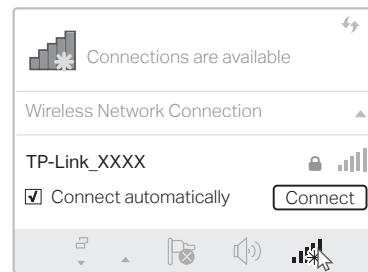

### Option 2: Via WPS Tool (If your adapter has a WPS button)

#### a. Press the WPS button on your router.

#### b. Within 2 minutes, press and hold the WPS button on the adapter until WPS Tool opens.

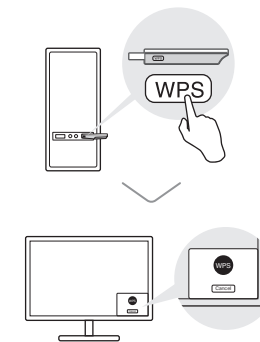

## FAQ



If you have questions during the installation, please refer to the following FAQs.

- Can't find the hardware version of the adapter: <https://www.tp-link.com/faq-46.html>
- Can't find or connect to the wireless networks: <https://www.tp-link.com/faq-2253.html>
- Can't install the driver: <https://www.tp-link.com/faq-2252.html>

## Support

For technical support, the user guide and other information, please visit <https://www.tp-link.com/support>, or simply scan the QR code.



- Do not attempt to disassemble, repair, or modify the device.
- Do not use the device where wireless devices are not allowed.
- Do not use damaged charger or USB cable to charge the device.
- Keep the device away from water, fire, humidity or hot environments.
- This USB Adapter can only be powered by computers that comply with Limited Power Source (LPS).