

ID1330

ViewBoard Pen Display

Quick Start Guide

Guide de démarrage rapide Schnellstartanleitung

Guía rápida de inicio

快速入門手冊



Overview

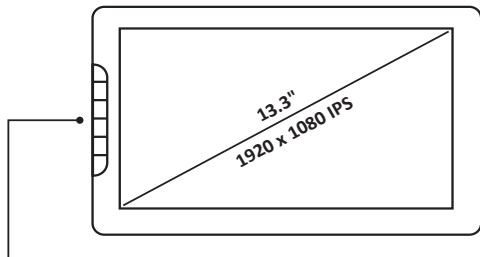

Shortcut keys(Six)

NOTE: The six shortcut keys can be customized as needed.

System Requirements

Windows: 7/8/10 or above

Mac OSX : 10.11 or above

Package Contents

- Stylus x1
- Pen Nibs x3 and Pen Nibs Remover x1
- Type-C to Type-C Cable x1
- Mini HDMI to HDMI Cable x1
- USB-A to Type-C Cable x1
- Quick Start Guide x1

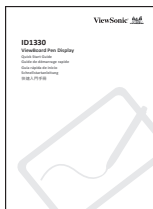
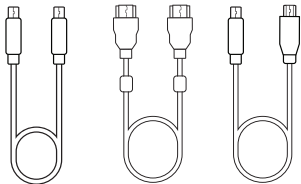
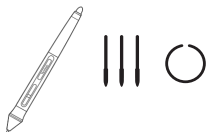
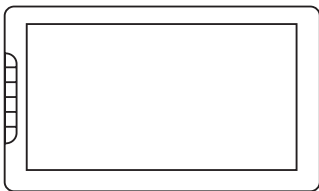

Connection

Type-C to USB & Mini HDMI to HDMI

- 1 Connect the Type-C/Mini HDMI end to the ID1330
- 2 Connect USB/HDMI end to your computer and Connect the USB/HDMI end to your computer, then press and hold the ID1330's power button for 3 seconds.

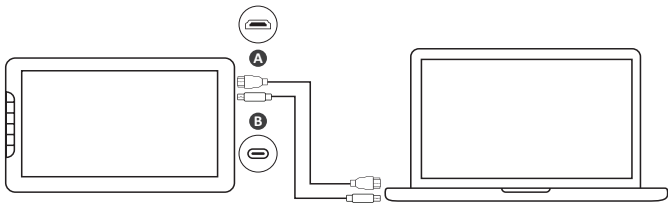

Type-C to Type-C

- 1 Connect the ID1330 to your computer using the Type-C cable and see above note. If you have black or blurred screen, please plug in the adapter for more power supply. Please plug in other adapter when you want to use over 70% brightness.

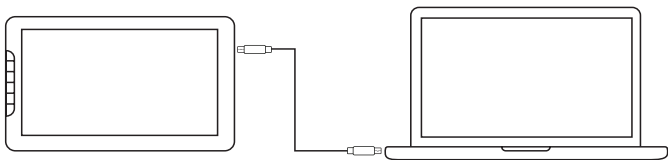

Setting Up the ID1330

Before Installing

- 1 Uninstall and completely remove any driver of other graphic tablets/monitors installed on your computer/laptop before.
- 2 Disable any anti-virus software and firewall temporarily.
- 3 Make sure you are installing the driver as an administrator.

Installation

- 1 Download and install the driver from: <https://pendisplay.viewsonic.com/pages/support-ID1330>
- 2 After a successful installation, reboot the computer.
- 3 Plug in the ID1330 and the system will show the "ViewSonic Pen Manager" icon in the system tray.

Changing the Pen Tip

- 1 Pull out the pen nib from the pen by using the nib removal tool.
- 2 Insert a new nib and push it into the pen.

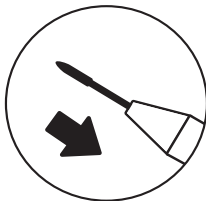
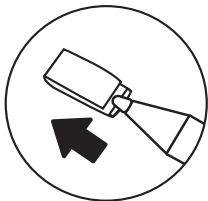

Important information

- 1 The user manual is uploaded into ViewSonic product page. It provides detailed information in using and customizing your ID1330
- 2 You may find a solution from FAQ if you have any questions with ID1330
- 3 Check for updated driver of ID1330 from Driver page: <https://pendisplay.viewsonic.com/pages/support-ID1330>

Support Option

- 1 Visit ViewSonic <https://pendisplay.viewsonic.com/pages/support-ID1330> for driver update, user manual and FAQ
- 2 Click “contact us” to send your enquiry

Vue d'ensemble

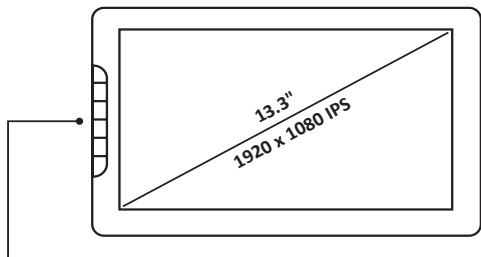

Touches express (6)

REMARQUE : Les 6 touches de raccourci peuvent être personnalisées si nécessaire.

Configuration système requise

Windows : 7/8/10 ou supérieur

Mac OSX : 10.11 ou supérieur

Contenu de la boîte

- Stylet passif x1
- Pointes de stylet x3 et pince à pointe x1
- Câble Type-C x1
- Câble HDMI x1
- Câble USB-A vers Type-C x1
- Guide de démarrage rapide x1

FRANCAIS

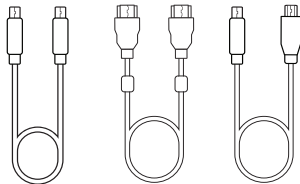
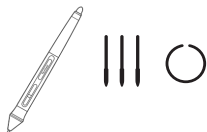
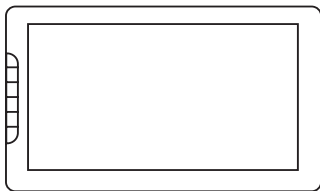

Connexion

Type-C vers USB et Mini HDMI vers HDMI à ID1330

- 1 Raccordez l'extrémité Type-C/Mini HDMI à ID1330
- 2 Raccordez l'extrémité USB/HDMI à votre ordinateur, appuyez et maintenez le bouton d'alimentation enfoncé pendant 3 secondes

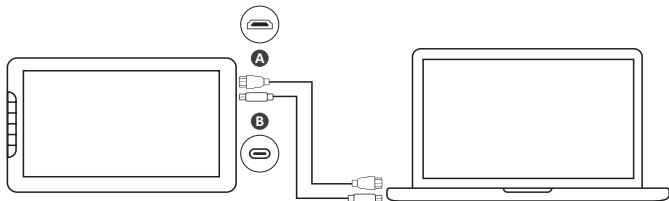

Type-C vers Type-C

- 1 Raccordez ID1330 à votre ordinateur à l'aide du câble Type-C et appuyez sur le bouton d'alimentation pendant 3 secondes. branchez un autre adaptateur lorsque vous souhaitez utiliser plus de 70% luminosité.

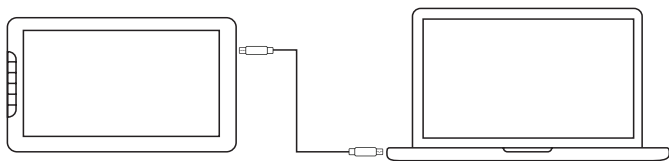

Configuration de ID1330

À savoir avant l'installation

- 1 Préalablement, désinstallez et supprimez complètement les pilotes des autres tablettes graphiques/moniteurs installés sur votre ordinateur portable/de bureau
- 2 Désactivez temporairement les logiciels antivirus et les pare-feu
- 3 Assurez-vous d'installer le pilote en tant qu'administrateur

Installation

- 1 Téléchargez et installez le pilote depuis : <https://pendisplay.viewsonic.com/pages/support-ID1330>
- 2 Après une installation réussie et un redémarrage
- 3 Branchez ID1330, le système affiche « ViewSonic Pen Manager » dans la zone de notification

Remplacement de la pointe du stylet

- 1 Retirez la pointe du stylet à l'aide de la pince à pointe
- 2 Remettez une nouvelle pointe et enfoncez-la dans le stylet

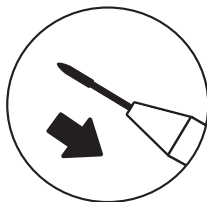
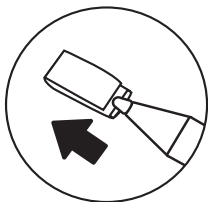

Informations importantes

- 1 Le manuel d'utilisation est téléchargé sur la page du produit ViewSonic. Il fournit des informations détaillées sur l'utilisation et la personnalisation de votre ID1330
- 2 Vous pouvez trouver des solutions dans la FAQ si vous avez des questions sur ID1330
- 3 Recherchez les mises à jour du pilote de ID1330 dans la page Pilote : <https://pendisplay.viewsonic.com/pages/support-ID1330>

Option de support

- 1 Rendez-vous sur la page ViewSonic <https://pendisplay.viewsonic.com/pages/support-ID1330> pour accéder aux mises à jour du pilote, au manuel d'utilisation et à la FAQ
- 2 Cliquez sur « Contact us » (Nous contacter) pour envoyer votre demande

Überblick

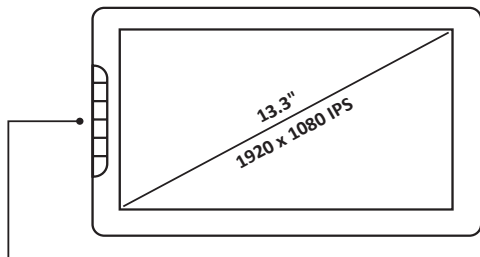

Schnellasten (6)

HINWEIS: Die 6 Shortcut-Tasten können je nach Bedarf angepasst.

Systemvoraussetzungen

Windows: 7/8/10 oder höher

Mac OSX: 10.11 oder höher

Lieferumfang

- Passiver Stift x1
- Stiftspitze x3 und Stifthalter x1
- Typ-C-Kabel x1
- HDMI-Kabel x1
- USB-A zu Typ-C-Kabel x1
- Schnellstartanleitung x1

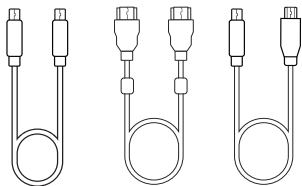
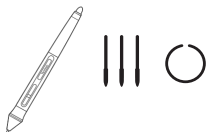
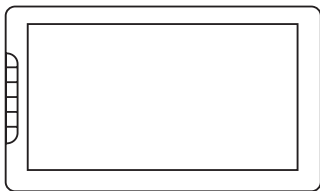

Verbindung

Typ-C zu USB und Mini-HDMI zu HDMI

- 1 Kabelende mit Typ-C/Mini-HDMI an ID1330 anschließen
- 2 Kabelende mit USB/HDMI an Ihren Computer anschließen und die Netztaaste 3 Sekunden lang gedrückt halten

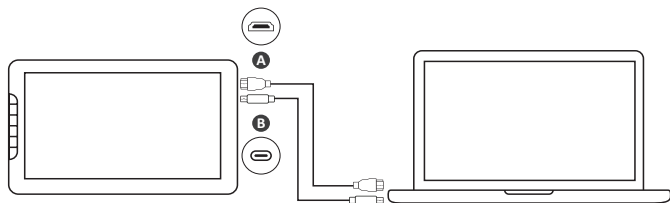

Typ-C zu Typ-C

- 1 ID1330 mit dem Typ-C-Kabel an Ihren Computer anschließen und die Netztaaste 3 Sekunden lang gedrückt halten. Lease-Stecker in anderen Adapter, wenn Sie über 70% verwenden möchten Helligkeit.

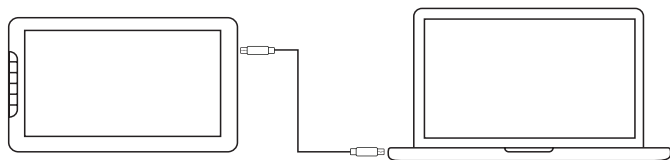

Einrichtung von ID1330

Wissenswertes vor der Installation

- 1 Auf Ihrem Computer/ Laptop installierte Treiber für andere Grafiktablets/ Bildschirme müssen deinstalliert und komplett entfernt werden
- 2 Antivirensoftware und Firewall müssen vorübergehend deaktiviert werden
- 3 Stellen Sie sicher, dass Sie den Treiber als Administrator installieren

Installation

- 1 Laden Sie den Treiber herunter und installieren Sie ihn:
<https://pendisplay.viewsonic.com/pages/support-ID1330>
- 2 Nach einer erfolgreichen Installation und einem Neustart
- 3 Stecken Sie ID1330 an und das System zeigt in der Taskleiste „ViewSonic Pen Manager“ an

Stiftspitze wechseln

- 1 Ziehen Sie die Stiftspitze mit dem Stiftclip aus dem Stift
- 2 Setzen Sie eine neue Stiftspitze ein und drücken Sie sie fest hinein

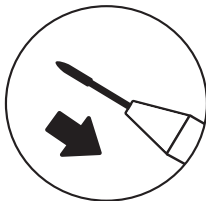
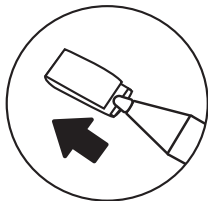

Wichtige Informationen

- 1 Die Bedienungsanleitung ist auf der ViewSonic-Produktseite verfügbar. Sie enthält ausführliche Informationen über den Gebrauch und die individuelle Anpassung Ihres ID1330
- 2 Bei Fragen zu ID1330 lesen Sie in den FAQs nach, ob Sie eine Antwort finden
- 3 Informieren Sie sich auf der Treiberseite, ob es neue Treiber für ID1330 gibt:
<https://pendisplay.viewsonic.com/pages/support-ID1330>

Support-Option

Auf unserer Website ViewSonic

- 1 <https://pendisplay.viewsonic.com/pages/support-ID1330> finden Sie Treiberaktualisierungen, Bedienungsanleitung und Antworten auf häufig gestellte Fragen.
- 2 Klicken Sie auf „contact us (Kontakt)“, um uns Ihre Anfrage zu senden

Información general

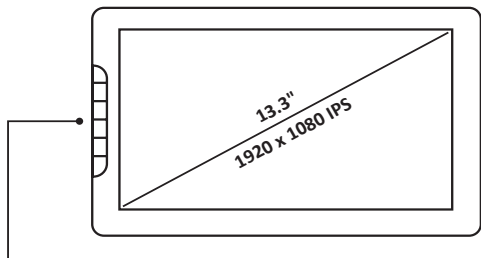

Botones rápidos (6)

NOTA: Los 6 botones de acceso directo se pueden personalizar según sea necesario.

Sistema requerido

Windows: 7/8/10 o superior

Mac OSX: 10.11 o superior

Contenido del paquete

- Lápiz pasivo x1
- Plumillas x3 y clip de plumilla x1
- Cable Tipo-C x1
- Cable HDMI x1
- Cable USB-A a Tipo-C x1
- Guía de inicio rápido x1

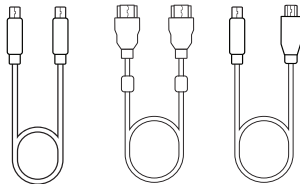
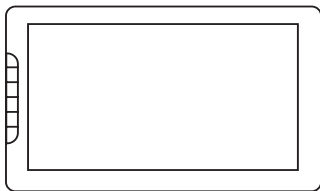

Conexión

Tipo-C a USB y Mini-HDMI a HDMI

- 1 Conecte el extremo Tipo-C/Mini-HDMI a ID1330
- 2 Conecte el extremo USB/HDMI a su PC y presione sin soltar el botón de alimentación durante 3 segundos

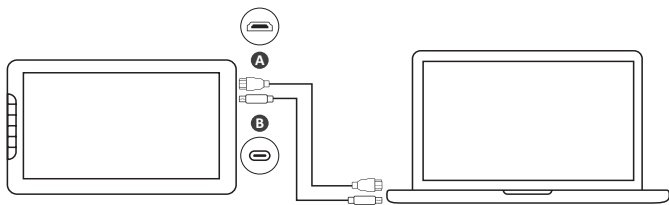

Tipo-C a Tipo-C

- 1 Conecte ID1330 a su PC mediante el cable Tipo-C y presione el botón de alimentación durante 3 segundos. Conecte otro adaptador cuando desee usar más del 70% brillo.

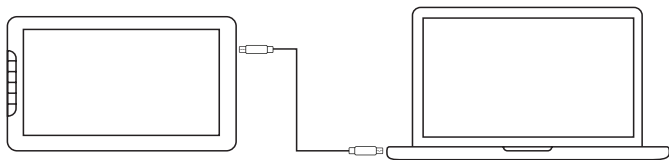

Configurar ID1330

Lo que debe saber antes de realizar la instalación

- 1 Desinstale y quite completamente cualquier controlador de otra tableta gráfica o monitor instalados en el equipo de sobremesa o portátil previamente
- 2 Deshabilite temporalmente cualquier software antivirus y firewall
- 3 Asegúrese de instalar el controlador como administrador

Instalación

- 1 Descargue e instale el controlador desde:
<https://pendisplay.viewsonic.com/pages/support-ID1330>
- 2 Después de una instalación correcta, reinicie
- 3 Enchufe ID1330 y el sistema mostrará "ViewSonic Pen Manager" en el icono de la bandeja

Cambiar la punta del lápiz

- 1 Saque la plumilla del lápiz utilizando el clip de plumilla
- 2 Reemplace una plumilla nueva, colóquela y empújela introduciéndola en el lápiz

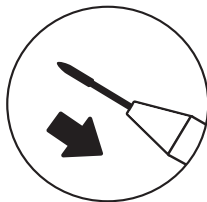
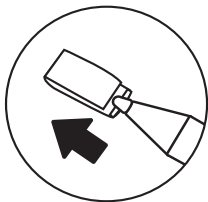

Información importante

- 1 El manual del usuario se carga en la página del producto ViewSonic. Proporciona información detallada sobre el uso y la personalización de sus ID1330
- 2 Puede encontrar una solución en las preguntas más frecuentes si tiene alguna pregunta sobre ID1330
- 3 Compruebe si hay alguna actualización del controlador de ID1330 en la página del controlador:
<https://pendisplay.viewsonic.com/pages/support-ID1330>

Opción de soporte

- 1 Visite ViewSonic <https://pendisplay.viewsonic.com/pages/support-ID1330> para buscar actualizaciones del controlador, del manual del usuario y de las preguntas más frecuentes
- 2 Haga clic en “contact us” (contacto) para enviar su pregunta

系統規格

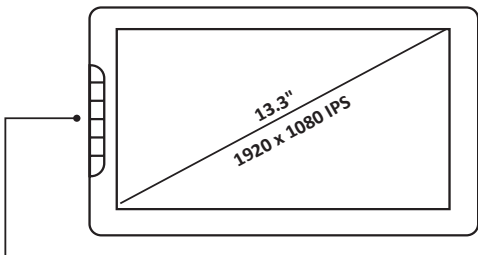

快捷鍵六個(6)

附註：快捷鍵功能可以由使用者在驅動程式中自行設定

系統需求

Windows: 7/8/10 以上

Mac OSX : 10.11 以上

內含物

- 無源電磁筆 x1
- 筆尖 x3 跟 筆尖夾 x1
- Type-C到Type-C電線 x1
- Mini HDMI到HDMI電線 x1
- USB-C到Type-A電線 x1
- 快速使用手冊 x1

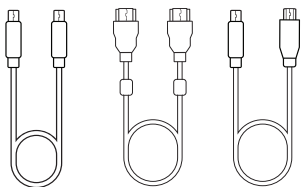
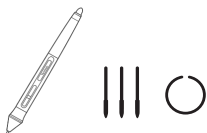
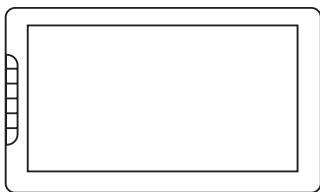

連接方式

Type-C 連接到 USB-A/mini HDMI 連接到 HDMI

- 1 插入 Type-C 跟 mini HDMI 線並連接到 ID1330
- 2 插入 USB-A 跟 HDMI 線到使用者電腦上，並按住電源鈕 3 秒即可開機

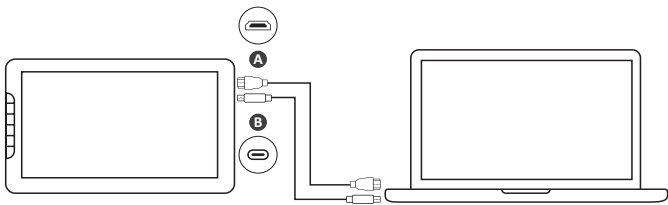

TypeC 連接到 Type-C

- 1 連接 Type-C 線到使用者電腦的 Type-C 插座並按住電源鈕 3 秒即可開機
附註:請確認使用者電腦的 Type-C 插座有支援數據跟足量的電源供應
如產生黑屏或是條紋狀畫面,即表示電腦供電不足,亦或使用超過 70% 的亮度,請另外接上外接電源供電

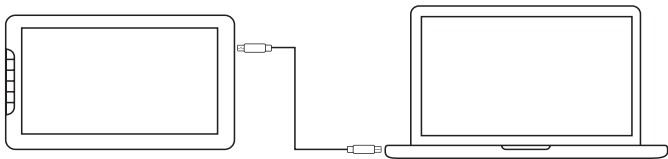

安裝ViewSonic ID1330

安裝須知

- 1 請移除使用者電腦中所有的繪圖板或是繪圖螢幕的驅動程式
- 2 請暫時關閉防毒軟體或是防火牆軟體
- 3 確認安裝驅動程式時, 有管理者權限

安裝

- 1 請到 <https://pendisplay.viewsonic.com/pages/support-ID1330>
- 2 成功安裝驅動程式後請重新開機
- 3 插入ID1330後, 系統列會出現"ViewSonic Pen Manager" 的圖示

更換筆尖

- 1 用筆夾夾住筆尖後, 往外拉出筆尖
- 2 更換新的筆尖後插入筆頭

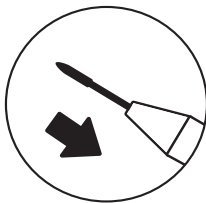
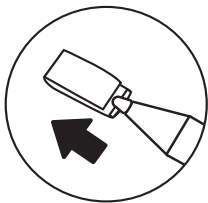

重要訊息

- 1 使用者可以到ViewSonic網站下載說明書來做更多的客製化設定跟使用方式說明
- 2 使用者也可以在常見問題的網頁找到ID1330的常用問題說明
- 3 任何更新的驅動程式也請到: <https://pendisplay.viewsonic.com/pages/support-ID1330> 下載

支援選項

- 1 請到 <https://pendisplay.viewsonic.com/pages/support-ID1330> 網頁下載驅動程式,使用手冊跟常見問題
- 2 有任何問題也歡迎利用電子郵件詢問



ViewSonic®