

MUSICAL FIDELITY

BALANCED POWER
CONDITIONER

BPC3

BALANCED POWER
CONDITIONER

BPC5

BALANCED POWER
CONDITIONER

BPC10

BALANCED POWER
CONDITIONER

BPC16

Instruction Manual

Manual in different languages available from www.musicalfidelity.com

Contents

Safety Information 3

Installation 4

BPC Compatibility Chart 5-6

Facilities & Connections 7-10

Troubleshooting..... 11

Technical Specifications..... 11-12

Statement of Conformity..... 13

Item Disposal Information for Europe 14

Safety Information

This unit is designed and built to provide trouble-free performance. As with all electronic devices it is necessary to observe a few precautions:

- Heed all warnings shown on the back of the product.
- Only connect the unit to a mains outlet having the same voltage as marked at the back of the unit.
- Always ensure that when disconnecting and reconnecting your audio equipment the mains supply is switched off.
- Position the mains lead and signal interconnects where they are not likely to be walked on or trapped by items placed on them.
- Do not use near water, or place water-filled containers on the device, for example, a flower vase or potted plants. If water does spill inside, immediately pull out the mains plug from the wall socket and inform the dealer, who should then check the unit before further use. Entry of liquid into the device is dangerous and may cause electric shock or fire hazard.
- Do not place the unit near direct heat sources such as radiators, direct sunlight or other equipment.
- Do not remove any covers or try to gain access to the inside. There are no user adjustments or fuses to change without qualification. Refer all service work to an authorized Musical Fidelity agent.

Note: Unauthorized opening of the equipment will invalidate any warranty claim.

The electronics in modern hi-fi equipment are complex and may, therefore, be adversely affected or damaged by lightning. For protection of the system during electrical storms, remove the mains plugs. If after-sales service is required, to help the dealer identify the product please quote the serial number located on the rear panel of the unit.

WARNING - This appliance MUST be earthed.

Precautions & User Information

WARNING: Any modifications to this product, not expressly approved by Musical Fidelity, who is the party responsible for standards compliance could void the user's authority

Installation

Introduction

This unit has been designed for maximum performance. It easily powers your speakers at high levels and allows you to fully enjoy audio and video sources with great dynamics.

Note: In normal operation, the unit dissipates a small quantity of power at all times, and it is important that it is adequately ventilated. The device must be protected from humidity – if the unit is moved from a cold place to a warm room, leave the unit for an hour or so to allow sufficient time for the moisture to evaporate.

Cleaning

Before cleaning the unit, switch off power at the mains switch and remove the mains plug from the wall socket. Clean the cabinet and remote-control unit using a moist cloth. Using solvents, white spirit or thinners is not advised, as they could damage the surface finish.

Installation

Position the unit on a stable, horizontal surface where there is no risk of it being knocked or subjected to vibration such as from loudspeakers.

Power Input Connections

The unit is supplied with a standard IEC mains cable which plugs into the IEC socket at the back of the unit.

Power Output Connections

Connect your analogue and digital sources, power amps and integrated amps to the power outputs on the back panel. Use good quality power cables or the cables your source or amplifier units were shipped with.

You can use the zones on the backpanel to split up your amplifier, digital and analogue source components. Amplifiers have the biggest power draw, so make sure to connect them to the zone with the most VA on your BPC. Additionally, confirm with your amplifier's manual that its power draw does not exceed the maximum power output of that zone. Use the chart on the next to pages to see which Musical Fidelity devices are best paired with which BPC and which zone.

Digital and analogue sources usually have much lower power requirements, so you'll be safe in almost all cases and all zones.

We recommend to split up digital and analogue source units. Use one zone exclusively for digital sources, like streamers, DACs and CD players. And connect analogue sources like preamplifiers or turntables to a different zone.

It's OK to mix and match analogue preamps with power amps, as long as the power amp leaves enough power for the preamp in the zone it's connected to.

BPC Compatibility Chart

product	type	BPC3		BPC5	
		300W	300W	200W	800W
A1	power amplifier	MA	MA	MA	MA
M2s/M3si	power amplifier	1	1	-	MA
M2/M3/M6s CD	digital source	MD	MD	MD	MD
M3/M6/M8xVinyl	analogue source	MA	MA	MA	MA
M3/M6/M8x DAC	digital source	MD	MD	MD	MD
M5/M6si	power amplifier	-	-	-	1
M6si500	power amplifier	-	-	-	-
M6s PRE	analogue source	MA	MA	MA	MA
M6s PRX	power amplifier	-	-	-	1
M8xi	power amplifier	-	-	-	-
M8s PRE	analogue source	MA	MA	MA	MA
M8s-700m	power amplifier	-	-	-	-
M8s-500s	power amplifier	-	-	-	-
V90-Blu5 HD	digital source	MD	MD	MD	MD
MX-Stream/DAC	digital source	MD	MD	MD	MD
Nu-Vista Vinyl	analogue source	MA	MA	MA	MA
Nu-Vista Vinyl 2	analogue source	MA	MA	MA	MA
Nu-Vista 600	power amplifier	-	-	-	1
Nu-Vista 600.2	power amplifier	-	-	-	1
Nu-Vista 800	power amplifier	-	-	-	-
Nu-Vista 800.2	power amplifier	-	-	-	-
Nu-Vista PAM	power amplifier	-	-	-	-
Nu-Vista PAS	power amplifier	-	-	-	-
Nu-Vista PRE	analogue source	MA	MA	MA	MA
Nu-Vista DAC/CD	digital source	MD	MD	MD	MD

MD: multiple digital sources. Connected more products from "digital sources" up to maximum output power of the zone.

MA: multiple analogue sources. Connected more products from "analogue sources" up to maximum output power of the zone.

1: single product in zone. Power consumption of the product is already close to maximum output power of the zone.

- : means that power consumption of the product exceeds the output power of the zone.

Don't mix analogue and digital sources in one zone.

Don't mix switch mode PSUs with toroidal/linear PSUs!

Don't mix power amplifiers with digital or analogue sources.

product	type	BPC10			BPC16		
		200W	200W	1550W	2000W	600W	600W
A1	power amplifier	MA	MA	MA	MA	MA	MA
M2s/M3si	power amplifier	-	-	MA	MA	1	1
M2/M3/M6s CD	digital source	MD	MD	MD	MD	MD	MD
M3/M6/M8xVinyl	analogue source	MA	MA	MA	MA	MA	MA
M3/M6/M8x DAC	digital source	MD	MD	MD	MD	MD	MD
M5/M6si	power amplifier	-	-	MA	MA	1	1
M6si500	power amplifier	-	-	-	1	-	-
M6s PRE	analogue source	MA	MA	MA	MA	MA	MA
M6s PRX	power amplifier	-	-	MA	MA	-	-
M8xi	power amplifier	-	-	-	1	-	-
M8s PRE	analogue source	MA	MA	MA	MA	MA	MA
M8s-700m	power amplifier	-	-	-	1	-	-
M8s-500s	power amplifier	-	-	1	1	-	-
V90-Blu5 HD	digital source	MD	MD	MD	MD	MD	MD
MX-Stream/DAC	digital source	MD	MD	MD	MD	MD	MD
Nu-Vista Vinyl	analogue source	MA	MA	MA	MA	MA	MA
Nu-Vista Vinyl 2	analogue source	MA	MA	MA	MA	MA	MA
Nu-Vista 600	power amplifier	-	-	MA	MA	1	1
Nu-Vista 600.2	power amplifier	-	-	MA	MA	1	1
Nu-Vista 800	power amplifier	-	-	1	MA	-	-
Nu-Vista 800.2	power amplifier	-	-	1	MA	-	-
Nu-Vista PAM	power amplifier	-	-	-	1	-	-
Nu-Vista PAS	power amplifier	-	-	-	1	-	-
Nu-Vista PRE	analogue source	MA	MA	MA	MA	MA	MA
Nu-Vista DAC/CD	digital source	MD	MD	MD	MD	MD	MD

MD: multiple digital sources. Connect more products from "digital sources" up to maximum output power of the zone.

MA: multiple analogue sources. Connect more products from "analogue sources" up to maximum output power of the zone.

1: single product in zone. Power consumption of the product is already close to maximum output power of the zone.

- : means that power consumption of the product exceeds the output power of the zone.

Don't mix analogue and digital sources in one zone.

Don't mix switch mode PSUs with toroidal/linear PSUs!

Don't mix power amplifiers with digital or analogue sources.

Facilities & Connections BPC16



1 Power/Standby button and LED's

The Power button turns the unit on or off. When turned on the left LED will light up blue. The right LED lights up green if the BPC is in regular working status. Should the right LED light up red, please check if your input voltage is correct (between 100V and 130V or 210V and 250V depending on which country you are in).

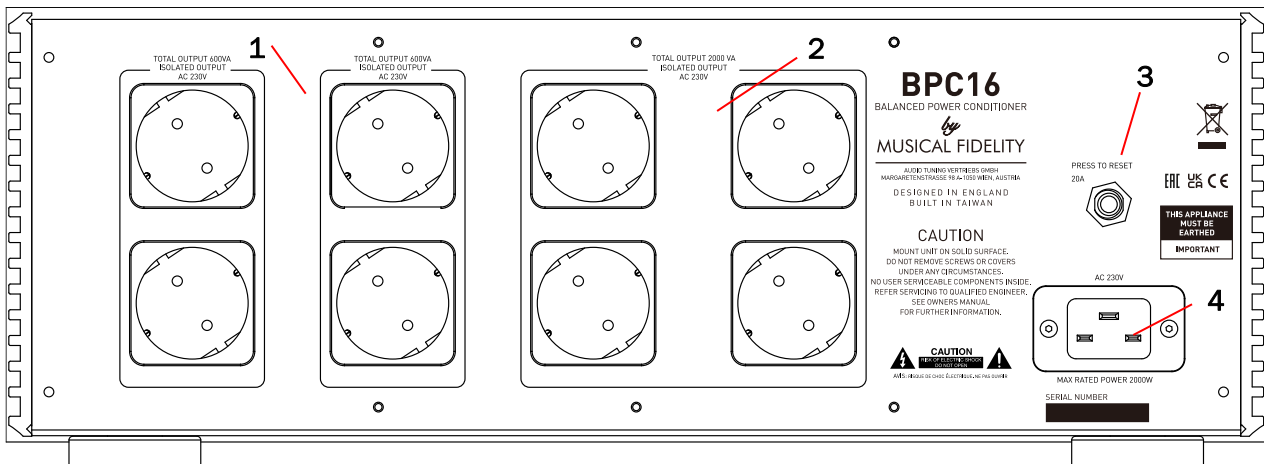

1 Isolated 600VA Output Zones

2 Isolated 2000VA Output Zone

3 Power Reset Switch

4 Mains IEC socket

Power Reset Switch

When the BPC detects an overload, the built in safety mechanism will prevent any damage to the BPC or the connected devices and turn off the BPC. If needed and an overload should have occurred, press the reset switch. Disconnect and connect all devices one by one in case you need to troubleshoot what is causing the overload.

Facilities & Connections BPC10



1 Power/Standby button and LED's

The Power button turns the unit on or off. When turned on the left LED will light up blue. The right LED lights up green if the BPC is in regular working status. Should the right LED light up red, please check if your input voltage is correct (between 100V and 130V or 210V and 250V depending on which country you are in).

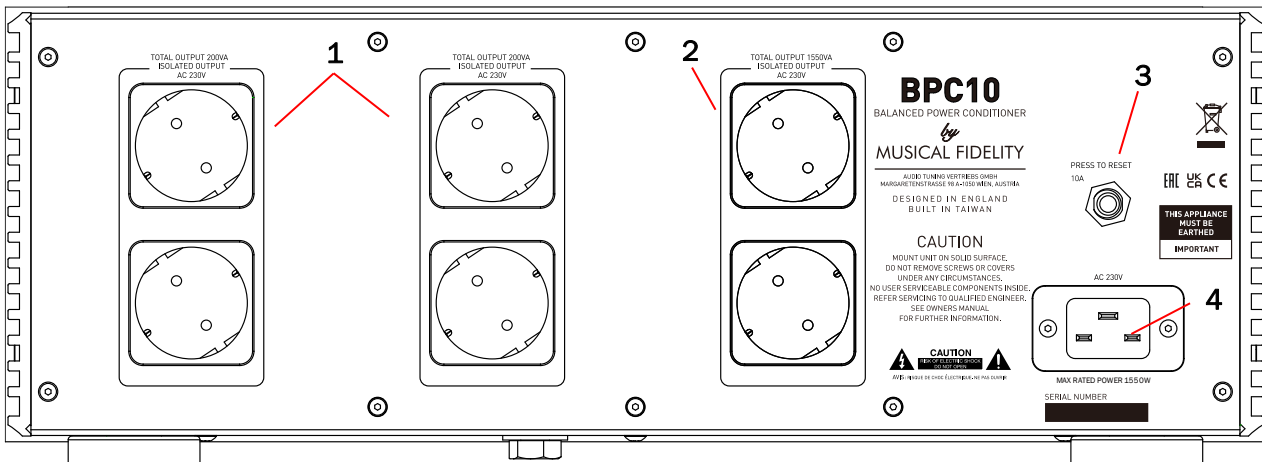

- 1 Isolated 200VA Output Zones
- 2 Isolated 1550VA Output Zone

- 3 Power Reset Switch
- 4 Mains IEC socket

Power Reset Switch

When the BPC detects an overload, the built in safety mechanism will prevent any damage to the BPC or the connected devices and turn off the BPC. If needed and an overload should have occurred, press the reset switch. Disconnect and connect all devices one by one in case you need to troubleshoot what is causing the overload.

Facilities & Connections BPC5

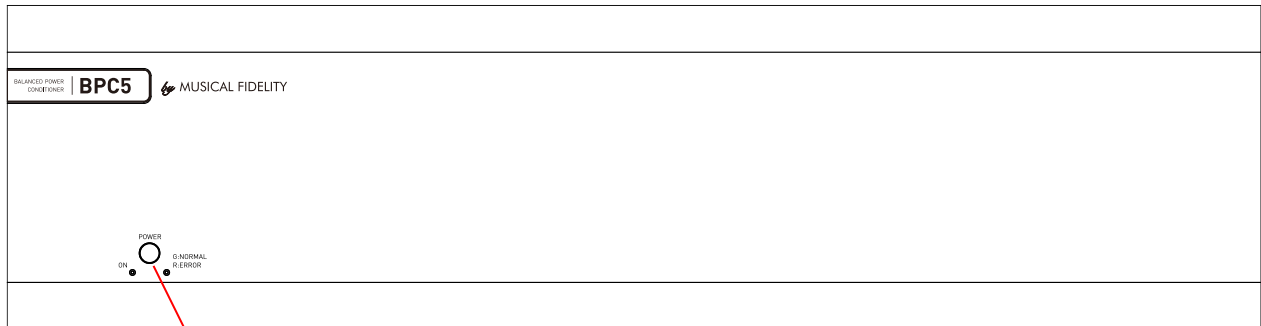

1

1 Power/Standby button and LED's

The Power button turns the unit on or off. When turned on the left LED will light up blue. The right LED lights up green if the BPC is in regular working status. Should the right LED light up red, please check if your input voltage is correct (between 100V and 130V or 210V and 250V depending on which country you are in).

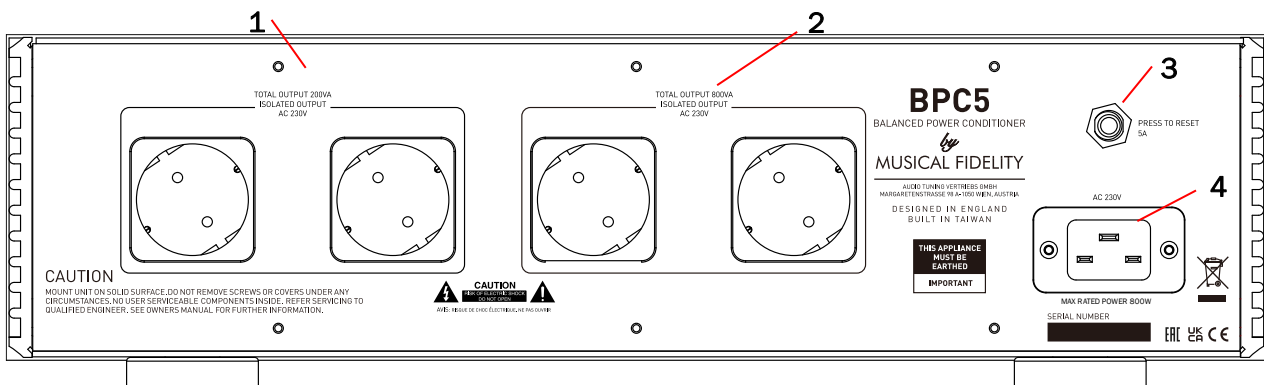

1 Isolated 200VA Output Zone

2 Isolated 800VA Output Zone

3 Power Reset Switch

4 Mains IEC socket

Power Reset Switch

When the BPC detects an overload, the built in safety mechanism will prevent any damage to the BPC or the connected devices and turn off the BPC. If needed and an overload should have occurred, press the reset switch. Disconnect and connect all devices one by one in case you need to troubleshoot what is causing the overload.

Facilities & Connections BPC3

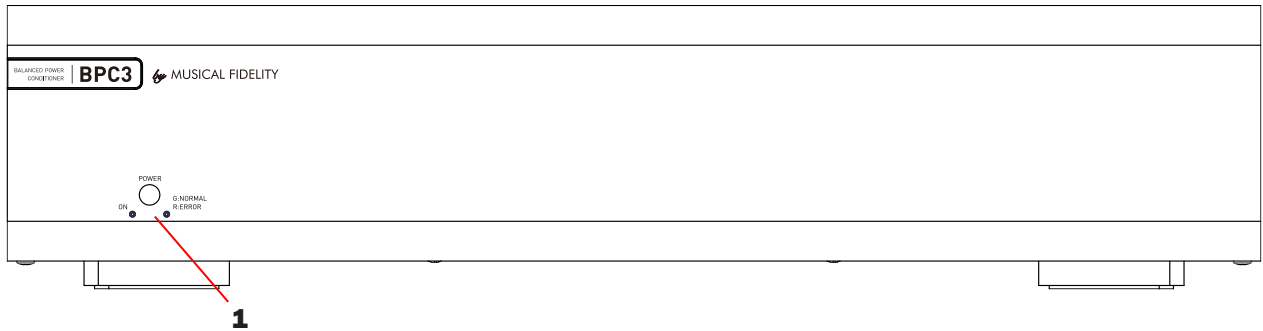

1 Power/Standby button and LED's

The Power button turns the unit on or off. When turned on the left LED will light up blue. The right LED lights up green if the BPC is in regular working status. Should the right LED light up red, please check if your input voltage is correct (between 100V and 130V or 210V and 250V depending on which country you are in).

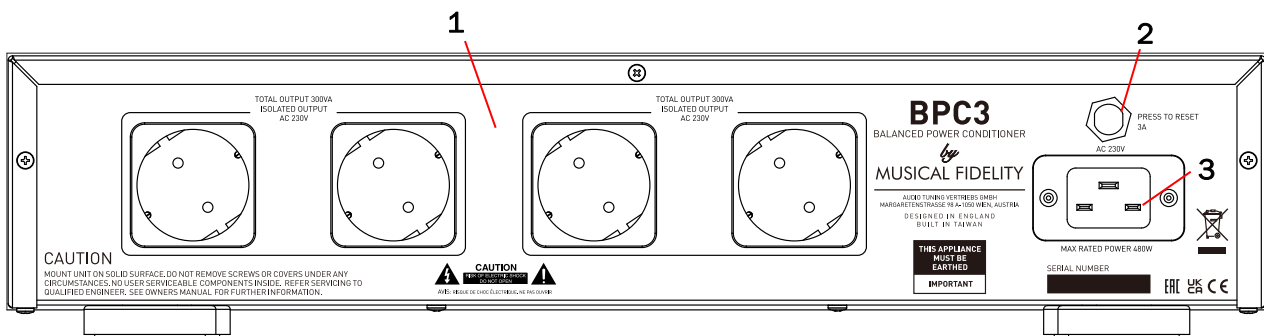

1 Isolated 300VA Output Zones

3 Mains IEC socket

2 Power Reset Switch

Power Reset Switch

When the BPC detects an overload, the built in safety mechanism will prevent any damage to the BPC or the connected devices and turn off the BPC. If needed and an overload should have occurred, press the reset switch. Disconnect and connect all devices one by one in case you need to troubleshoot what is causing the overload.

Troubleshooting

Problem	Probable Cause	Remedy
No power	Power plug is not inserted into socket correctly.	Plug in securely into unit's IEC socket.
Power LED lights up red	Wrong input voltage.	Check your mains voltage and make sure you have the correct BPC for your country.
BPC does not turn on.	BPC went into overload protection mode.	Press Reset Button on back panel and make sure connected devices are not causing power overload on BPC. If necessary, disconnect all devices and reconnect them one by one.

Technical Specifications BPC16

Output Voltage RFI attenuation	100-130V/210-250V > 57dB @ 235kHz, > 40dB @ up 1MHz
Connections Power Outlets Isolated Power Zones Peak Combined Power Output Maximum Rated Power Output	8 Outlets 2x 600VA zones, 1x 2000VA zone 5000VA / 20A 2000VA / 16A
Power requirement Mains voltages Max. power consumption	100-130V/210-250V. AC 50/60Hz 2000W
Weight Unit only, unboxed In shipping carton & inc. accessories	38,9 kg ca. 44,5 kg
Unit dimensions Wide High, including feet Deep (front to back) including terminals	440 mm 162 mm 400 mm

Technical Specifications BPC10

Output Voltage RFI attenuation	100-130V/210-250V > 57dB @ 235kHz, > 40dB @ up 1MHz
Connections Power Outlets Isolated Power Zones Peak Combined Power Output Maximum Rated Power Output	6 Outlets 2x 200VA zones, 1x 1550VA zone 2400VA / 10A 1550VA / 10A
Power requirement Mains voltages Max. power consumption	100-130V/210-250V. AC 50/60Hz 1550W

Weight Unit only, unboxed In shipping carton & inc. accessories	33 kg ca. 39,5 kg
Unit dimensions Wide High, including feet Deep (front to back) including terminals	440 mm 162 mm 400 mm

Technical Specifications BPC5

Output Voltage RFI attenuation	100-130V/210-250V > 57dB @ 235kHz, > 40dB @ up 1MHz
Connections Power Outlets Isolated Power Zones Peak Combined Power Output Maximum Rated Power Output	4 Outlets 1x 200VA zone, 1x 800VA zone 1200VA / 5A 800VA / 5A
Power requirement Mains voltages Max. power consumption	100-130V/210-250V. AC 50/60Hz 800W
Weight Unit only, unboxed In shipping carton & inc. accessories	20,6 kg ca. 25 kg
Unit dimensions Wide High, including feet Deep (front to back) including terminals	440 mm 125 mm 400 mm

Technical Specifications BPC3

Output Voltage RFI attenuation	100-130V/210-250V > 57dB @ 235kHz, > 40dB @ up 1MHz
Connections Power Outlets Isolated Power Zones Peak Combined Power Output Maximum Rated Power Output	4 Outlets 2x 300VA zones 600VA / 3A 480VA / 3A
Power requirement Mains voltages Max. power consumption	100-130V/210-250V. AC 50/60Hz 480W
Weight Unit only, unboxed In shipping carton & inc. accessories	11,7 kg ca. 15,5 kg
Unit dimensions Wide High, including feet Deep (front to back) including terminals	440 mm 100 mm 400 mm

Musical Fidelity reserves the right to make improvements which may result in specification or feature changes without notice.

Statement of Conformity

Musical Fidelity Balanced Power Conditioners comply with the following regulations:

EN 55032:2015 + A1:2020	Measurement of Conducted Emission, Measurement of Radiated Field
EN IEC 61000-3-2:2019 + A1:2021	Measuring of Harmonic Current Emissions
EN 61000-3-3:2013+A1:2019+A2:2021	Measuring of Voltage Variation Reduction and Flickering Reduction in the Mains
EN 55035:2017 + A11:2020	EMC IMMUNITY
EN 61000-4-2:2009	Electrostatic Discharge
EN IEC 61000-4-3:2020	Radiated Electromagnetic Field
EN 61000-4-4:2012	Electrical Fast Transients/Burst Immunity
EN 61000-4-5:2014 +A1:2017	Surge Immunity
EN 61000-4-6:2014	Conducted Disturbances Induced by RF Fields
EN IEC 61000-4-11:2020	Short-time Breaks and Drop-outs of Supply Voltage
EN IEC 62368-1: 2020 + A11: 2020	Electrical Safety Test of Audio/Video, Information and Communication Technology Equipment

They are therefore in conformity with relevant union harmonisation legislation directives:

- 2014/35/EU
- 2014/30/EU

The entire BPC family was rigorously tested to ensure it complies with highest industry standards for electrical safety and electromagnetic interference mitigation. Tested by an accredited institute, adhering to strict international guidelines, no corners have been cut to guarantee performance and reliability.

Test Institute

Institute for Testing and Certification, a.s., Testing Laboratory No. 1004.3
 Sokolovska 573
 686 01 Uherske Hradiste
 Czech Republic



Test Report No: 414105221AE1, 414105255AL1

The electrical safety protocols test the device's insulation, grounding, and fault protection mechanisms. They ensure that Musical Fidelity Balanced Power Conditioners operate within safe parameters, reducing the risk of electrical hazards to an absolute minimum. Exhaustive electromagnetic interference tests gauge the effective shielding against unwanted interference from external sources, guaranteeing pristine audio quality without any disruptive artifacts. Musical Fidelity Balanced Power Conditioners successfully meet and surpass all criteria, providing you with the peace of mind that your valuable HiFi equipment is in the best possible hands.

As this is the first time that Musical Fidelity releases Power Conditioners to the market, we have been quite surprised by our market research and product analysis. There is a constant lack of documentation and safety documents when it comes to these types of products. With Musical Fidelity Balanced Power Conditioners, you can trust that your HiFi system is in the care of a device that has been extensively and independently validated by a reputable accredited test institute. This dedication to quality ensures that you'll enjoy the highest standard of sound performance, free from the compromises often seen in lesser quality power solutions.

Item Disposal Information for Europe



DISPOSAL

The crossed out wheeled bin label that appears on the back panel of the product indicates that the product must not be disposed of as normal household waste. To prevent possible harm to the environment please separate the product from other waste to ensure that it can be recycled in an environmentally safe manner. Please contact your local government office or your retailer for available collection facilities.

DISPOSITION

La poubelle sur roulettes barrées X, qui apparaît en logo sur le panneau arrière du produit, indique que celui-ci ne doit pas être traité comme un déchet domestique commun. Afin de protéger l'environnement, ce produit électronique devra être géré séparément et donc recyclé selon les nouvelles normes Européennes Rohs concernant les déchets d'appareils électroniques. Prière de contacter les services concernés gouvernementaux ou votre point de vente pour l'élimination et l'enlèvement de déchets électroniques équipés de composants électroniques.



DISPOSAL

La etiqueta cruzada hacia fuera del compartimento que aparece en el panel trasero del producto indica que el producto no se debe reciclar como basura normal de la casa. Para prevenir daños posible al ambiente separe por favor el producto de otras basura para asegurarse de que puede ser reciclada de una manera ambientalmente segura. Entre en contacto por favor a su oficina gubernamental local o a su minorista para las instalaciones disponibles de la colección.

RIFIUTI

L'etichetta del cassonetto barrato riportato sul retro dell'apparecchio indica che il prodotto non deve essere smaltito tramite la procedura normale di smaltimento dei rifiuti domestici. Per evitare eventuali danni all'ambiente, separare questo prodotto da altri rifiuti domestici in modo che possa venire riciclato in base alle procedure di rispetto ambientale. Per maggiori dettagli sulle aree di raccolta disponibili, contattate l'ufficio governativo locale od il rivenditore del prodotto.

FACHGERECHTE ENTSORGUNG:



Das auf der Geräterückseite angebrachte Label deutet darauf hin, dass das Produkt nicht mit konventionellem Hauskehricht entsorgt werden darf. Um Schäden und Verschmutzungen an Umwelt und Mensch zu vermeiden, muss das Produkt fachgerecht entsorgt und von anderem Abfall getrennt werden. Wenden Sie sich bei Fragen hierzu an Ihren Fachhändler oder an eine öffentliche Informationsstelle.

AFVAL

Het label op de achterzijde van dit apparaat, een afvalbak op wielen met een kruis doorgehaald, geeft aan dat dit apparaat niet samen met gewoon huishoudafval mag worden weggegooid. Om mogelijke schade aan onze leefomgeving te voorkomen dient dit apparaat, gescheiden van gewoon huishoudelijk afval, te worden afgevoerd zodat het op een milieuvriendelijke manier kan worden gerecycled. Neem voor beschikbare inzamelplaatsen contact op met uw gemeentelijke reinigingsdienst of met uw elektronica leverancier.



HÄVITTÄMINEN

Yliyksattua jäteastiaa kuvaava tarra tuotteen takalevyssä kertoo, että tuotetta ei saa käsitellä normaalina talousjätteenä. Ympäristön suojelemiseksi on tuote pidettävä erillään muusta jätteestä ja se on kierrätettävä ekologisesti kestävällä tavalla. Ota yhteyttä laitteen myyjään tai Pirkanmaan Ympäristökeskukseen lähimmän kierrätyskeskuksen löytämiseksi.



AFSKAFNING

Logoet med en skraldespand med kryds over på bagsiden af apparatet indikerer at dette produkt ikke må kasseres som normal husholdningsaffald. For at forebygge mulig skade på miljøet, bedes De separere dette produkt fra andet affald, og sikre at det bliver genbrugt på en miljørigtig måde. Kontakt venligst de lokale myndigheder eller din forhandler for oplysning om nærmeste tilgængelige opsamlingssted for elektronikaffald.



ΔΙΑΔΙΚΑΣΙΑ ΑΠΟΡΡΙΨΗΣ

ΤΟ ΣΗΜΑ ΜΕ ΤΟΝ ΔΙΑΓΕΓΡΑΜΜΕΝΟ ΤΡΟΧΗΛΑΤΟ ΚΑΔΟ ΑΠΟΡΡΙΜΑΤΩΝ ΣΤΗΝ ΠΙΣΩ ΟΨΗ ΤΟΥ ΜΗΧΑΝΗΜΑΤΟΣ ΔΗΛΩΝΕΙ ΟΤΙ ΤΟ ΠΡΟΙΟΝ ΑΥΤΟ ΔΕΝ ΠΡΕΠΕΙ ΝΑ ΔΙΑΧΕΙΡΙΣΘΕΙ ΣΑΝ ΣΥΝΗΘΙΣΜΕΝΟ ΟΙΚΙΑΚΟ ΑΠΟΒΛΗΤΟ. ΠΡΟΣ ΑΠΟΦΥΓΗ ΕΝΔΕΧΟΜΕΝΗΣ ΕΠΙΒΑΡΥΝΣΗΣ ΤΟΥ ΠΕΡΙΒΑΛΛΟΝΤΟΣ, ΞΕΧΩΡΙΣΤΕ ΤΟ ΠΡΟΙΟΝ ΑΠΟ ΤΑ ΑΛΛΑ ΑΠΟΡΡΙΜΑΤΑ ΩΣΤΕ ΝΑ ΕΞΑΣΦΑΛΙΣΘΕΙ Η ΑΝΑΚΥΚΛΩΣΗ ΤΟΥ ΜΕ ΤΟΝ ΠΡΕΠΟΝΤΑ ΤΡΟΠΟ. ΠΑΡΑΚΑΛΟΥΜΕ ΝΑ ΕΠΙΚΟΙΝΩΝΗΣΕΤΕ ΜΕ ΤΗΝ ΤΟΠΙΚΗ ΥΠΗΡΕΣΙΑ ΑΝΑΚΥΚΛΩΣΗΣ Η ΜΕ ΤΟ ΚΑΤΑΣΤΗΜΑ ΑΓΟΡΑΣ ΓΙΑ ΠΕΡΙΣΣΟΤΕΡΕΣ ΛΕΠΤΟΜΕΡΕΙΕΣ.

