

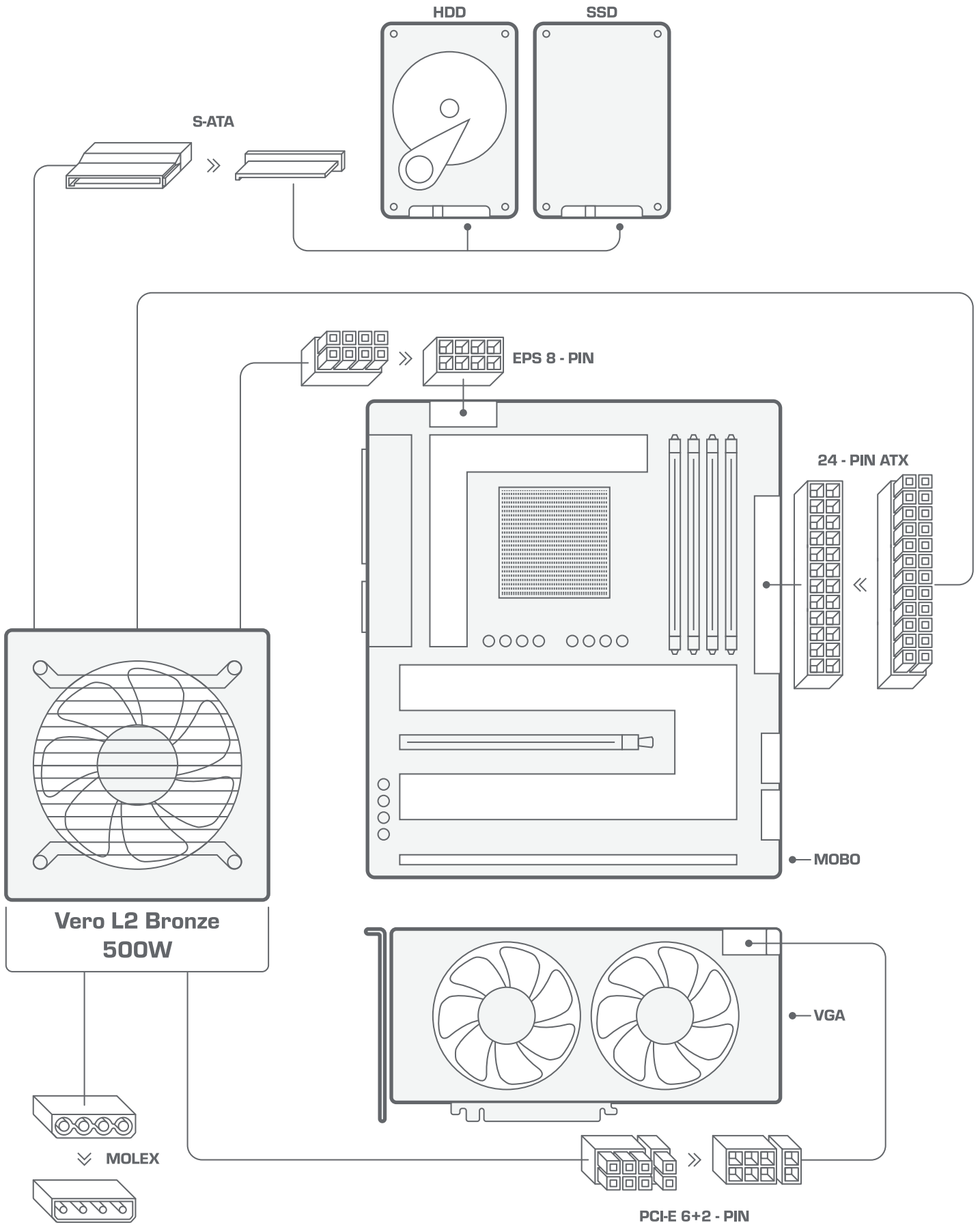

SILENTIUMPC

# MANUAL

Vero L2 Bronze 500W



# Vero L2 Bronze 500W

AC INPUT / WEJŚCIE 100~240V, 10-5A, 63Hz-47Hz Active PFC  
ATX 12V 2.31 EPS 12V 2.91/2.92 and older

DC Output	+12V	+3.3V	+5V	-12V	+5VSB
Max A	41	15	15	0.3	2,5
Max W	492	75	3.6	12,5	
<b>Total</b>	<b>500W</b>				

