

This product is intended for installation only by expert users. Please consult with a qualified technician for installation. Improper installation may result in damage to your equipment. Before you start using this product please follow these basic guidelines:

1. Please read carefully through the instruction manual before beginning the installation process.
2. Please remove your graphics card from your motherboard to ensure the safest process and in order to prevent any possible damages to your CPU and motherboard.
3. It is strongly recommended using market proven pre-mix coolant, such as Thermaltake Coolant 1000.

Parts List

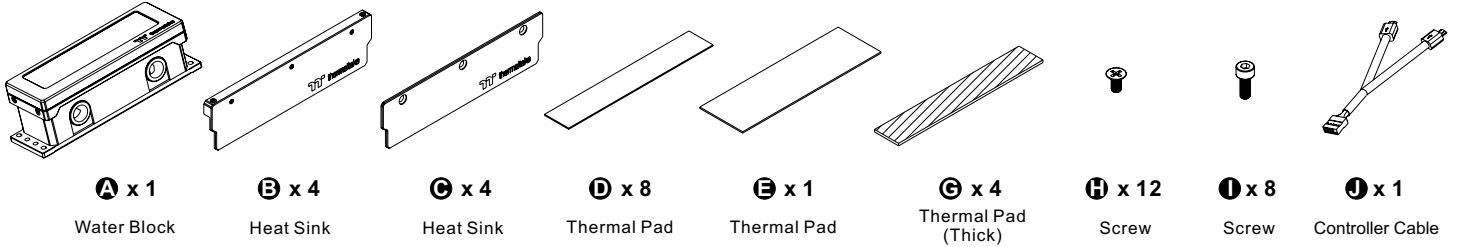

Memory Module Installation Guide

Please confirm the RAMs are single sided or double sided, single sided please refer to Type 1, double sided please refer to Type 2.

Type 1

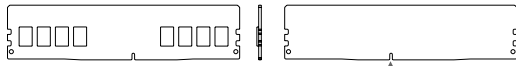

Type 2

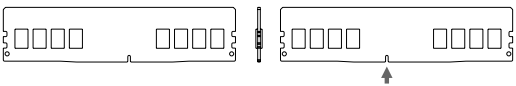

Type 1

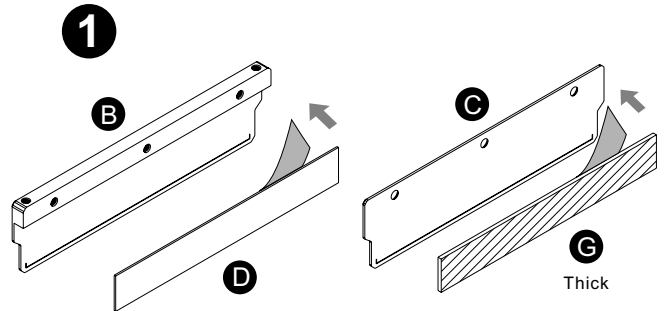

Attach Thermal Pad(D) to the Heat Sink(B)

Attach Thermal Pad(G) to the Heat Sink(C)

2

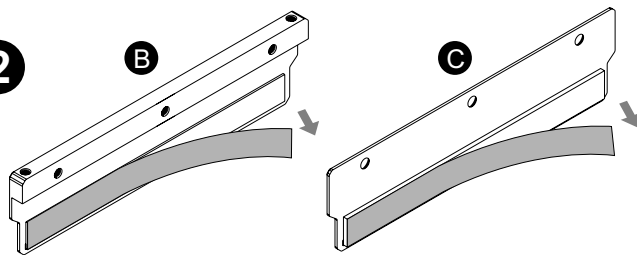

Remove the protective film of Thermal Pad on Heat Sink(B) and Heat Sink(C).

3

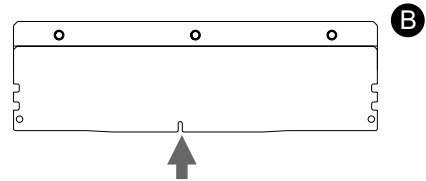

Install the RAMs on Heat Sink(B). Please be aware of the direction and the position.

4

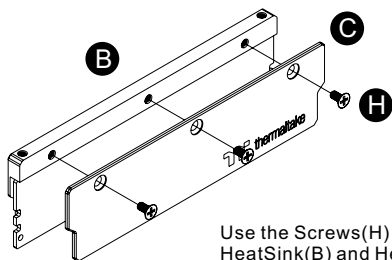

Use the Screws(H) to enclose the HeatSink(B) and HeatSink(C).

5

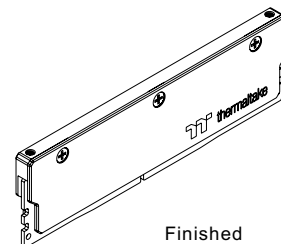

Finished

Memory Module Installation Guide

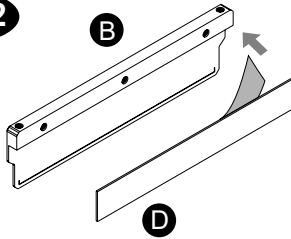
Type 2
1

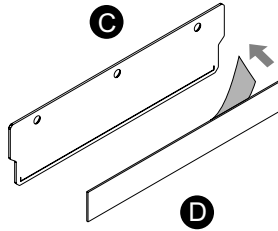
 Attach Thermal Pad(D)
to the Heat Sink(B)

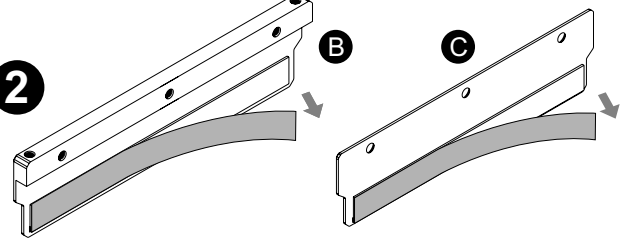
C

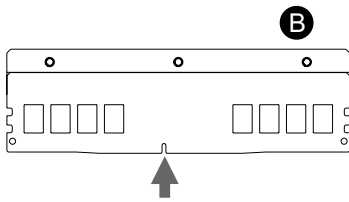
 Attach Thermal Pad(D)
to the Heat Sink(C)

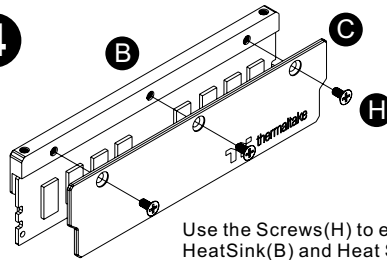
2

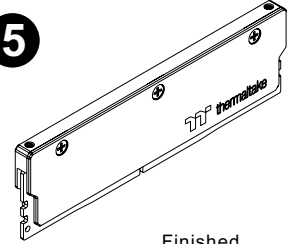
 Remove the protective film of Thermal Pad
from Heat Sink(B) and Heat Sink(C)

3

 Install the RAMs on Heat Sink(B).
Please be aware of the direction and the position.

4

 Use the Screws(H) to enclose the
HeatSink(B) and Heat Sink(C).

5

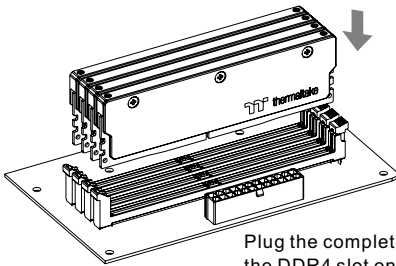
Finished

Installation Guide

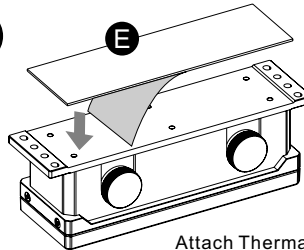
1

 Plug the complete memory module to
the DDR4 slot on the motherboard.
Please refer to the motherboard manual
for the installation location.

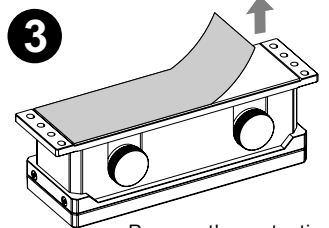
2

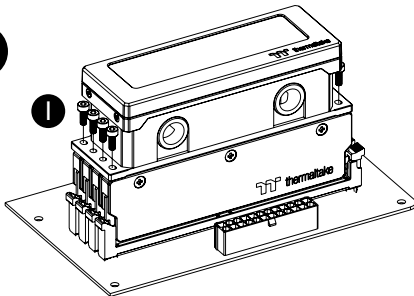
 Attach Thermal Pad(E)
to the Water Block(A).

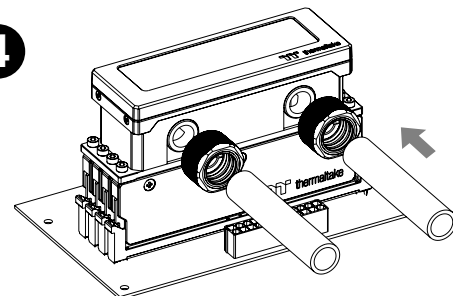
3

 Remove the protective
film of Thermal Pad
from the Water Block(A).

3

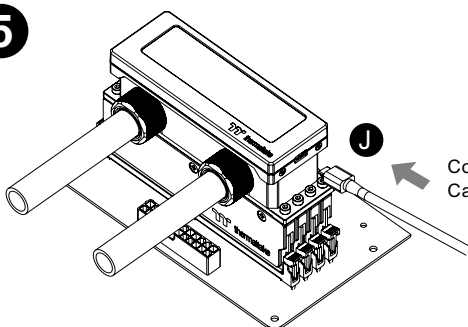
 Tighten the Screws(I)
until memory module
are securely attached.

4

Install your fittings and tubes

5

 Connect the Controller
Cable to Water Block